

WALL FACING BOARD



*A replacement for a plywood
in lower price*

Cello Bubble Guard Wall Facing Board is used as a replacement for the plywood. It can be directly fixed at the back of the cupboard, showcases, dressing tables, tv trolley etc by nailing it. But do use the **washer** while nailing it. It is available in various designs, mica shades which **does not need any paint or polish**. This will save your time & money.

Standard available sizes are 8ft x 4ft,
6ft x 4ft.

Standard available thickness is 6 mm.

INSTALLATION GUIDE

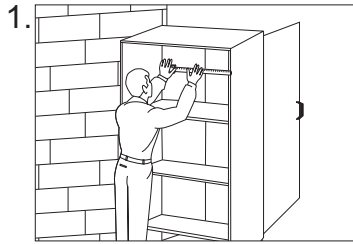

1. Take the size of the back of the cupboard.

2. Cut the cello bubble guard sheet accordingly.

3. Put the sheet on the back of the cupboard

4. Do the nailing using **washer** to fix the sheet.

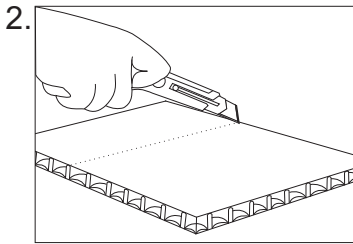

And the Water Proof & Termite Proof wall facing board is ready to protect your expensive furnitures from the moisture of the wall as well to give it a new look.

